



We're in this Together™

ProPet Washer 7.0



Overview

The ProPet Washer 7.0 incorporates up to 7 products with a rinse option to safely bathe animals. The different products are easily selected by the turn of a knob. Different dilution ratios are available through utilizing metering tips in the product barbs. Rinse and bathe functions are easily chosen through the use of push button water valves.

Specifications

Packing List

PART NO.	QTY	DESCRIPTION
100.16V.34	7	Product Foot Valve and Tubing
44.3.6QC	1	Inlet Hose 6'
44.3.4	1	Outlet Hose 4'
61.9K.DAV	4	Metering Tip Kit
98.40.4	1	Mounting Hardware Kit
40.14QD.8	1	Spray Gun with Q.C, no ball valve w/QC
292QD	1	Foam Wand Assembly
41.565.2.KIT	1	Shower head nozzle w/ QC
11388	1	ProPet Washer 7.0 Instruction Sheet
X41686.1	1	Davis ProPet Washer 7.0 L/Acc. Unit
67.27	1	Davis Cap Kit

Operational Requirements

- **Water Pressure:** 30 PSI minimum, 100 PSI maximum
- **Water Temperature:** 40 F minimum, 120 F maximum
- **Minimum Water Flow:** 2.6 GPM @ 30 PSI

Overall Size

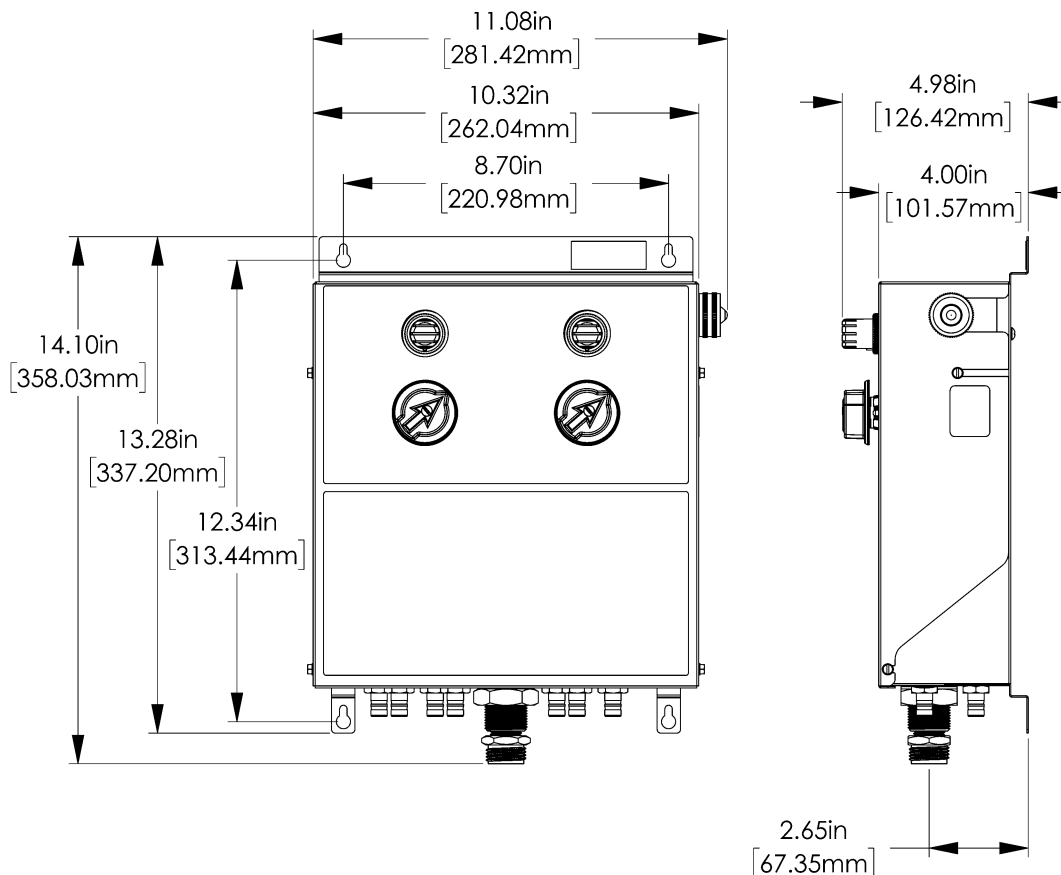

Parts List

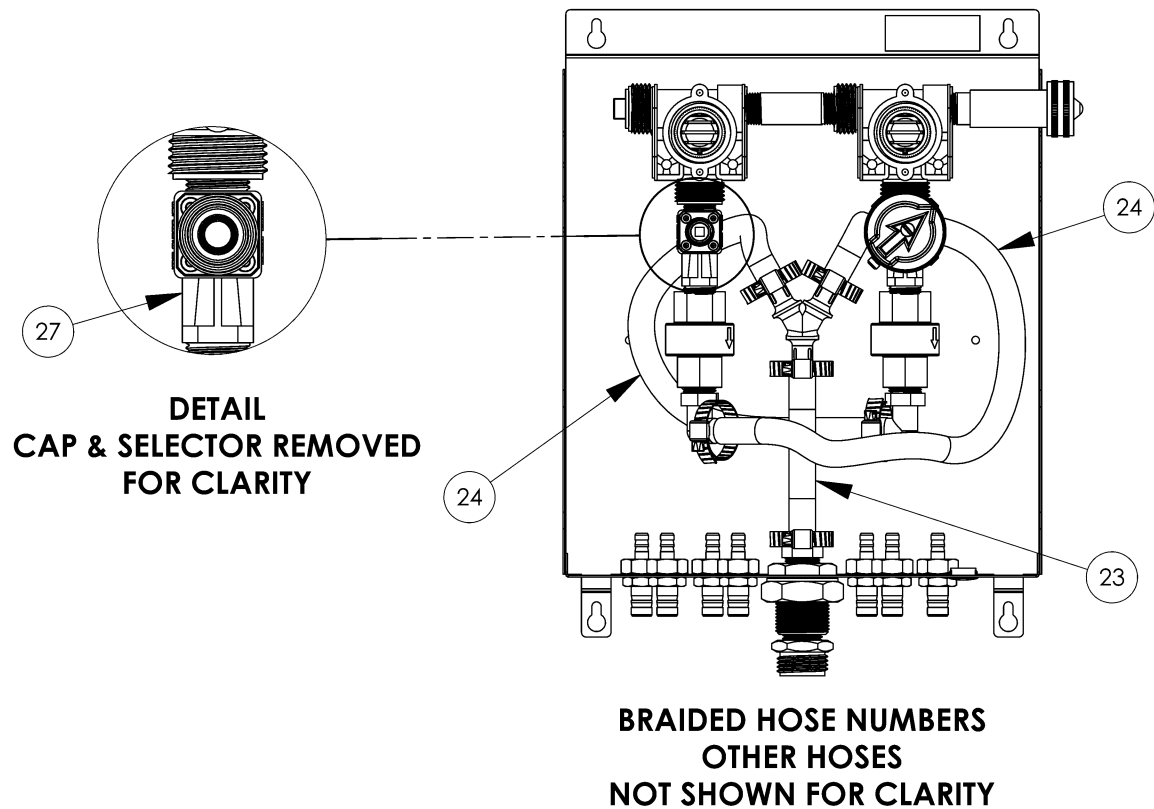
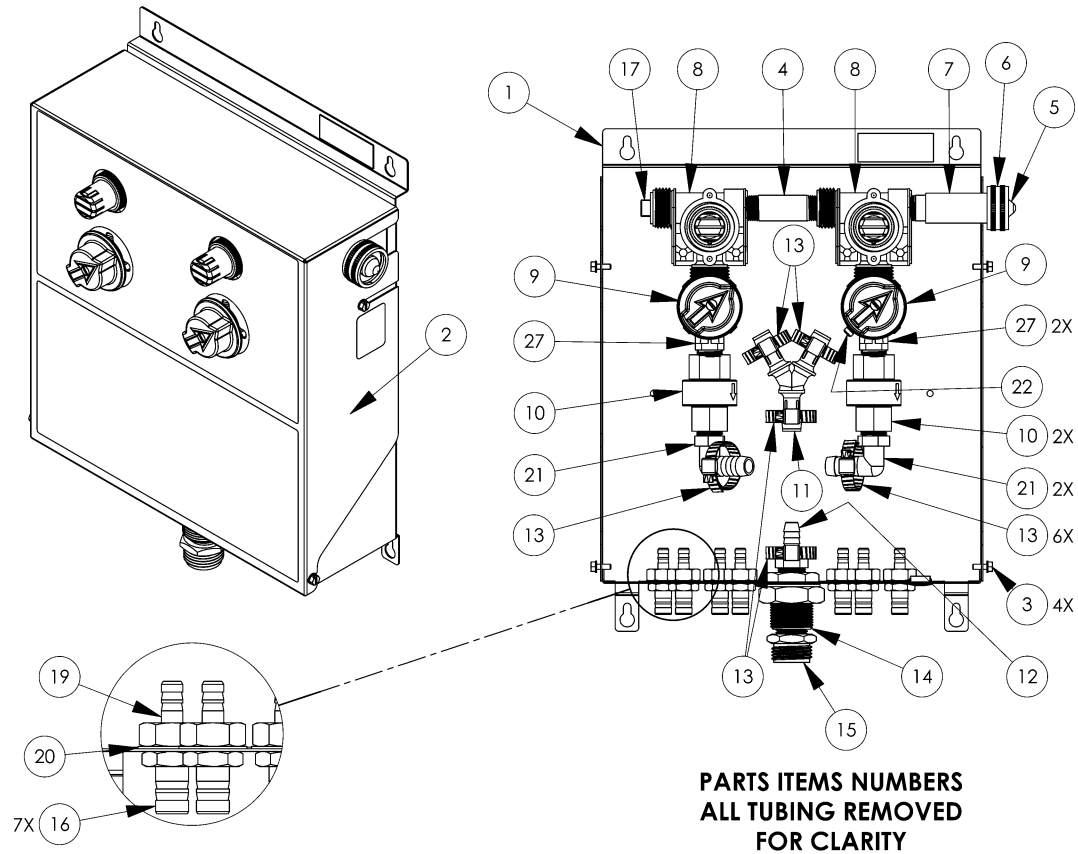

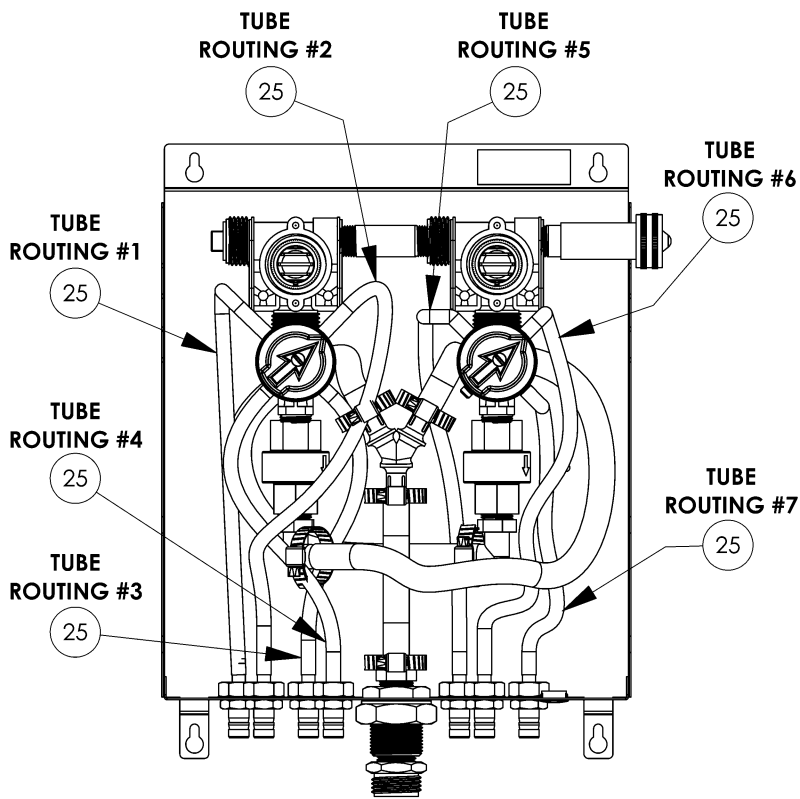

**NO COVER SHOWN FOR CLARITY
SMALL TUBING PART NUMBERS**

ITEM NO.	QTY	PART NO.	DESCRIPTION
1	1	41618.1	HOUSING, SHEETMETAL, WASH 6795
2	1	41619.1	COVER, SHEETMETAL, WASH 6795
3	4	68.9	SCREW; SS; 8-18 X 3/8; HHS
4	1	99.5.3	PIPE NIPPLE, 3/8" SCH. 40 BRASS PIPE, 2 1/2"
5	1	100.38	STRAINER WASHER
6	1	65.10.2	COUPLING, NICKEL PLATED
7	1	65.14.2	HOSE FITTING, MEDIUM LONG
8	2	633LNN.O.NOTAB	VALVE, BLACK MAGNET HOUSE, BLACK BUTTON, NO TAB
9	2	63.53.1	SELECTOR L/ACC.
10	2	95.23	CHECK VALVE 3/8 NPT
11	1	40.209.1	TUBING, WYE (1/2" TUBE)
12	1	24.77.20	HOSE BARB, 1/2" X 1/2" NPT POLY.
13	6	76.2.1	WORM GEAR CLAMP
14	1	41548.1	THROUGH-WALL STRAIGHT CONNECTOR, 1/2" NPT FEMALE, BRASS
15	1	41543.1	3/4" MALE HOSE/ 1/4" FEMALE PIPE ADAPTER
16	7	610.1.1	BARB BULK-HEAD, FITTING
17	1	66.153	PIPE PLUG/O-RING ASSEMBLY
18	2	44.116.1	#8 HI-LO SCREW X 1/2" LONG
19	7	29.233.1	NUT, HEX
20	7	29.234.1	WASHER, INTERNAL TOOTH LOCK
21	2	14.9.1	ELBOW, 3/8" NPT X 1/2" BARB
22	1	100.15.18	METERING TIP, BLANK-BLUE GREY
23	1	26.870.18	HOSE, BRAIDED - 3.5" LONG
24	2	26.870.17	HOSE, BRAIDED - 14" LONG
25	7	100.12.27	VINYL TUBING, 12" LONG 7/32" ID X 3/8" OD
26	1	41549.2	LOCKING PANEL PLUG FOR 17/32" ID FOR .016"-.062" PANEL THICKNESS
27	2	X41691.1	INJECTOR, SUB-ASSEMBLY, ProPet Washer 7.0

Installation

Dispenser Installation: ProPet Washer

The unit should be installed in a convenient place with easy access to a water source as well as proximity to where the products will be stored safely.

1. Find a proper place to mount the ProPet Washer 7.0 to be able to easily connect to a water supply and safely store Products. If possible, locate at least 2 of the screw holes on a stud in the wall.
2. Use the enclosed mounting hardware kit to mount the unit.
 - a. The hardware kit contains screws and anchors. A ¼” drill should be used to pilot the anchors.
3. Securely place the unit on the wall.

Inlet & Outlet Hoses

1. Connect the inlet hose to the right garden hose fitting on the unit. Then connect the hose to a water source of mixed hot and cold water.
2. Ensure the water source meets the stated operational requirements as found on page two (2).
3. Connect the outlet hose to the bottom garden hose fitting on the unit.
4. Locate the spray gun and nozzle. Attach to the end of the outlet hose.
 - a. Blue sprayer is for medium to large sized animals.
 - b. Grey sprayer is for small to medium sized animals.
5. Water flow is turned On/Off by the black water valve button on the dispenser only.

Product Tubing

The products should be placed below the unit. It is recommended that the products sit as close underneath the unit as possible.

1. Locate the enclosed tubing and foot valves for product connection.
2. Place the proper tubing and foot valve to the proper barb on the unit.
3. From left to right the barbs are numbered 1 through 7 for the selector located on the front of the unit.
4. Measure and cut the tubing to length, removing the excess tubing, then place foot valve in the product and tubing end onto barb.
5. Make sure the pickup tubes run through the holes on the enclosed caps and that the cap is fully tightened on the shampoo or conditioner bottle. This will help prevent hair and debris from getting into the bottle which could clog the induction ports and cause the dispenser to fail.

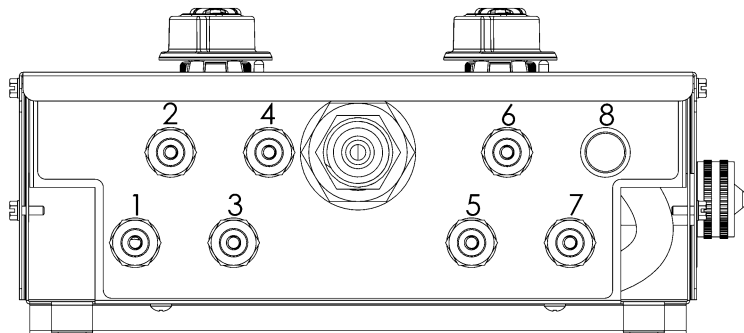

Operation

Priming the Products

It is recommended to prime the system once the unit is on the wall. Do not put the metering tips in the unit before priming. To do this, follow these steps.

1. Ensure that all hoses have been attached correctly including inlet, outlet, and product hoses.
2. Make sure water is turned on at the source.
3. Start with the selector on product 1. Press and turn the activation button on the dispenser.
4. Once it is obvious that the product is making it through to the outlet hose, deactivate the valve to turn off the water.
5. Repeat these steps for the remaining 6 products.

***It is highly recommended that warm water be used to flush the system at least once a month to reduce the chance of clogging. Take pickup tubes and place in a warm bucket of water and dispense. Once all lines have been flushed, reprime the lines using the above procedure.**

Dilution Ratios

Once you have primed the products, then dilution ratios can be set. The dilution ratios are controlled by placing metering tips in the barbs on the bottom of the unit. The following steps will go through how to install a metering tip.

1. Remove the product tubing from the desired barb.
2. Use the metering tips from the tip kit included with the unit. Use the tables below to help determine the right size tip for each product. The table lists the orifice size; a smaller orifice will let through less product, while a larger orifice will let through more product.
3. If a tip is attempted and too much product is coming through, move to a smaller sized tip by going up on the table. If a tip is attempted and too little product is coming through, move to a larger sized tip by going down on the table.
4. The tip will thread into the barb where the product tubing was. Once the tip is fully threaded into hand-tight, replace the tubing over the barb checking for a secure fit for proper function.
5. Repeat for as many dilution ratios as necessary.
6. It is recommended to start with the smallest size and test on an animal for an accurate representation. (Fur and hair affect foaming).

DILUTION RATIOS		
TIP COLOR	RATIO	AVG Oz./Gal.
Purple	147:1	0.87
Green	47:1	2.72
Black	25:1	5.18
Blue	16:1	8.14
Orange	13:1	9.87
None	12:1	10.78

Dilution Ratios Continued

Once the products have been primed and the dilutions have been set, the unit is ready to be operated. Begin by following the steps listed below.



WARNING: The unit should not be operated without foot valves on the pickup tubing, the metering tips will clog from debris.

1. Use selector to choose product to dispense.
2. Depress corresponding push button to dispense product.
3. Use the spray gun fully to dispense either water or a product solution.
4. If the unit is not working properly, see the troubleshooting section below for common issues.

Troubleshooting

Problem	Cause	Solution
Product Not Priming	<ol style="list-style-type: none"> 1. Pick up tubing is loose or cracked. 2. Foot valve is clogged. 3. No/low water pressure to unit. 4. Not enough vacuum. 5. Both push buttons are activated. 	<ol style="list-style-type: none"> 1. Check all tubing connections and make sure that a good fit is achieved. Check tubing for cracks. Replace if necessary. 2. Inspect foot valve for clogs. Clean if necessary. 3. Check to ensure water is on at the source and at 30 psi min. 4. Spray gun or hand held nozzle is clogged or damaged (If brass nozzle on the gun is damaged, replace) 5. Deactivate valve button not intended to be used.
Nothing Coming Out of Unit	<ol style="list-style-type: none"> 1. No water to unit. 2. Unit not turned on. 	<ol style="list-style-type: none"> 1. Check to ensure the water source is turned on. 2. Check to ensure the water valve is activated.
Too Much / Too Little / No Product	<ol style="list-style-type: none"> 1. Too much product is coming out, change or add a metering tip. 2. Too little, the foot valve is partially clogged. 3. Too little, the metering tip is too small. 4. No Product, metering tip clogged 5. Outlet water flow may be restricted 	<ol style="list-style-type: none"> 1. See the section above on metering tips to choose one with a smaller orifice. 2. Check the foot valve for partial clogs, clean if necessary. 3. See the section above on metering tips to choose one with a larger orifice. 4. Remove product tubing, take out metering tip and clean. 5. Fully open spray gun. Remove quick disconnect nozzle and test. Hose may be too long.
Water Flowing into Product Line.	<ol style="list-style-type: none"> 1. Selector check valve is clogged. 2. Both valves are activated. 3. Outlet of the sprayer gun or nozzle is completely blocked. 	<ol style="list-style-type: none"> 1. Remove Selector Valve from product. Place in a clean bucket of hot water free from debris. Run bathe option until tube and check valve is flushed, repeat with each tube if necessary. Replace selector if necessary. 2. Turn off one valve. 3. Clean out nozzle
Takes Too Long to Get Product Mix	<ol style="list-style-type: none"> 1. Vacuum is reduced or not present. 	<ol style="list-style-type: none"> 1. Check the metering tips, injector, and selector for debris and/or clogs. Clean or replace components as necessary.

Warnings



All installations must conform to local plumbing codes and use approved backflow prevention devices. A pressure indicating tee is to be installed with existing faucets according to local plumbing codes in the state of Wisconsin and any other state that requires the use of a pressure indicating tee.



ALWAYS WEAR PROTECTIVE CLOTHING AND EYEWEAR WHEN WORKING WITH CHEMICAL PRODUCTS.

Warranty

Merchandise Returns

No Merchandise will be Returned for Credit Without Davis Manufacturing's Written Permission. Returned Merchandise Authorization Number is Required in Advance of Return.

Product Warranty

The Davis ProPet Washer is warranted against defective material and workmanship under normal use and service for one year from the date of manufacture. This limited warranty does not apply to any products that have a normal life shorter than one year or failure and damage caused by chemicals, corrosion, physical abuse, or misapplication. Rubber and synthetic rubber parts such as "O"-rings, diaphragms, PVC tubing, and gaskets are considered expendable and are not covered under warranty. This warranty is extended only to the original buyer of the Davis ProPet Washer. If products are altered or repaired without prior approval of Davis Manufacturing, this warranty is void.

Defective units or parts should be returned to the factory with transportation prepaid. If inspection shows them to be defective, they will be repaired or replaced without charge, F.O.B. factory. Davis Manufacturing assumes no liability for damages. Return merchandise authorization number must be granted in advance of returned units for repair or replacement (See "Merchandise Returns" above).

Propet Washer 7.0 WALL MOUNT TEMPLATE

